

1.8 Degree Stepper Motor with Gearhead

COBHAM

PN 16229

2016 Data Sheet

The most important thing we build is trust

Specification	16229	16243	Units	Basis
Gear Ratio	4:1	10:1	ratio	by design
Output Step Angle	0.45	0.18	degrees	nominal
Running Torque	140	345	in-oz	nominal
Holding Torque	228	570	in-oz	nominal
Unpowered Torque	38	95	in-oz	nominal
Backlash	0.5	0.5	degrees	maximum
Weight	2.1	2.2	pounds	nominal



Motor Specification	Value	Units	Basis
Step Angle	1.8	degrees	nominal
Step Rate	780	pps	maximum
Voltage	36	volts DC	maximum
Power	8	watts	maximum
Phase Resistance	62	ohms	nominal
Phase Inductance	79	mH	nominal
Phases/Poles	2/50	phases/poles	by design
Redundant Windings	yes	windings	by design

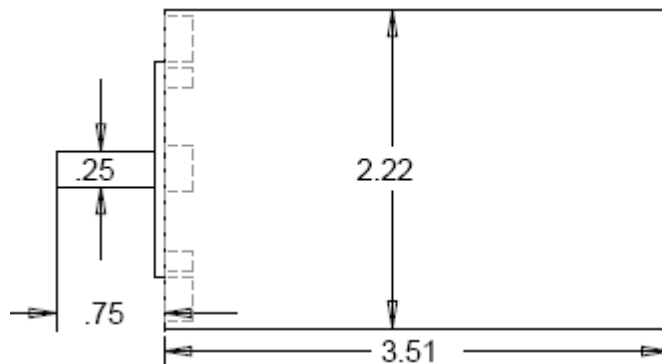
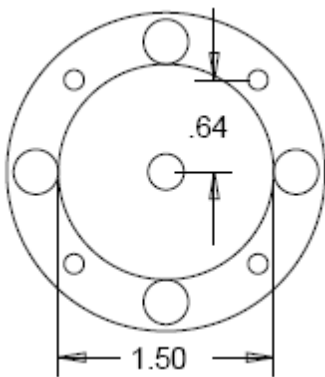

Cobham Advanced Electronic Solutions

Integrated Electronic Solutions

Tel: 1.631.231.9100

Email: motion.sales@cobham.com

www.cobham.com