

Power 500 kHz Current Sense Transformers 7086-7088

- Frequency range from 200 to 500 kHz
- 20 Amp peak sense current
- 1500 Vrms isolation

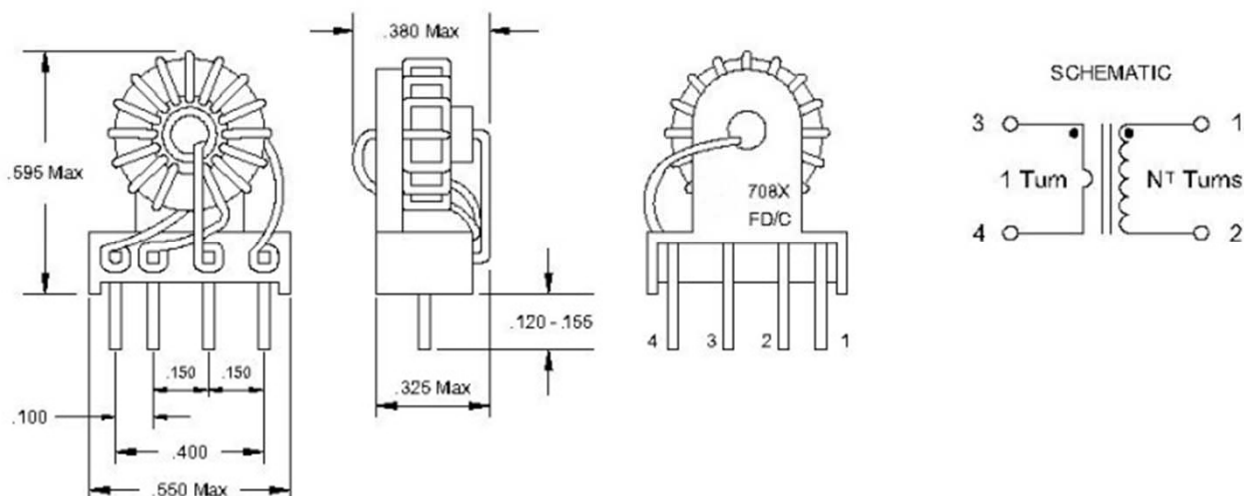

MECHANICAL AND SCHEMATIC (All dimensions in inches)



UNLESS OTHERWISE SPECIFIED, ALL TOLERANCES ARE ± 0.010

ELECTRICAL SPECIFICATION @ 25°C

Part Number	RT ¹ (Ω)	Secondary Turns ² N _T	Secondary Inductance ³ (μ H Min)	DCR Secondary (Ω Max)	DCR Primary (Ω)	V _S (mV)
7086	1.50	10	150	.055	.006	30
7087	3.00	20	600	.097	.006	60
7088	7.50	50	4000	.240	.006	160

1. Terminating resistance for .15 Volt/Amp

2. ± 1 turn

3. Measured @ 100 kHz, @ V_S